



Model: WS NC for Lutron Designer Style 1Gang 5/8"

Model No.: 10-01-306

Family: WALL-SMART

DWG NO. 10-04-306-SPC

PRODUCT SPEC.

REVISION B

DATE 17/MAR/2024



Make Your Wall Smart

“WS for Lutron Designer Style 1Gang 5/8” - Product description:

The “WS for Lutron Designer Style 1Gang 5/8” is an adapter for in-wall flush installation of a Lutron Designer style 1 gang faceplate and line voltage decora® style accessories.

The “WS for Lutron Designer Style 1Gang 5/8” firmly mounts the Designer Style products while allowing easy access, insertion and operation.

Key features and benefits:

- Flush with the wall.
- Includes depth calibration mechanism.
- Paintable with the wall paint in any color and texture.
- Allows easy insertion and removal of the faceplate and accessories.
- The adapter is supplied unpainted (To be painted after installation as part of the wall).
- Designed to be installed in 5/8” drywall. Installation of the Wall-Smart adapter is straight-forward. Installation process is similar to drywall construction procedures. Before installation, read Wall-Smart installation instruction 10-04-00101-INS in <http://www.wall-smart.com/faq>
- Designed for the use with Designer Style 1 gang faceplate and line voltage decora® style accessories (by Lutron) (Lutron Designer style faceplate, line voltage decora® style accessories and back box are not included).
- Adapter kit contains:
 1. Wall adapter (x1)
 2. KA3.5X8 Screws (x4)
 3. Installation spacer (M4 nuts) (X2)

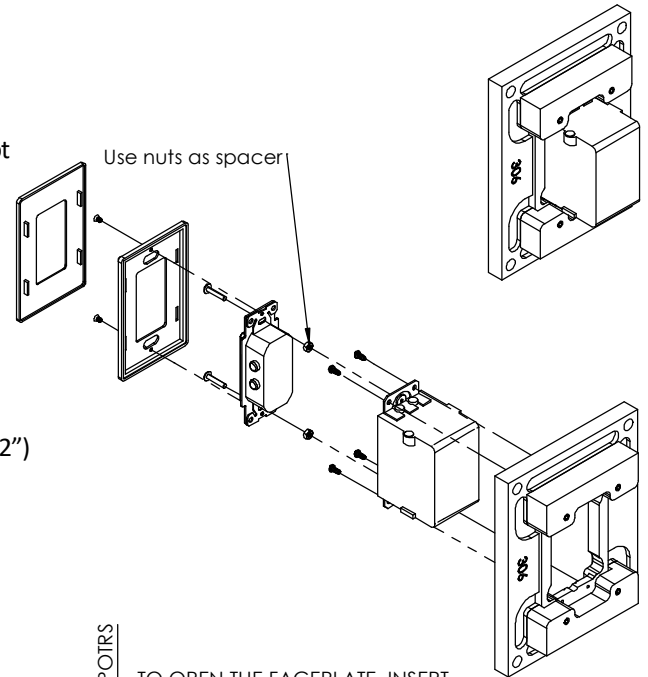
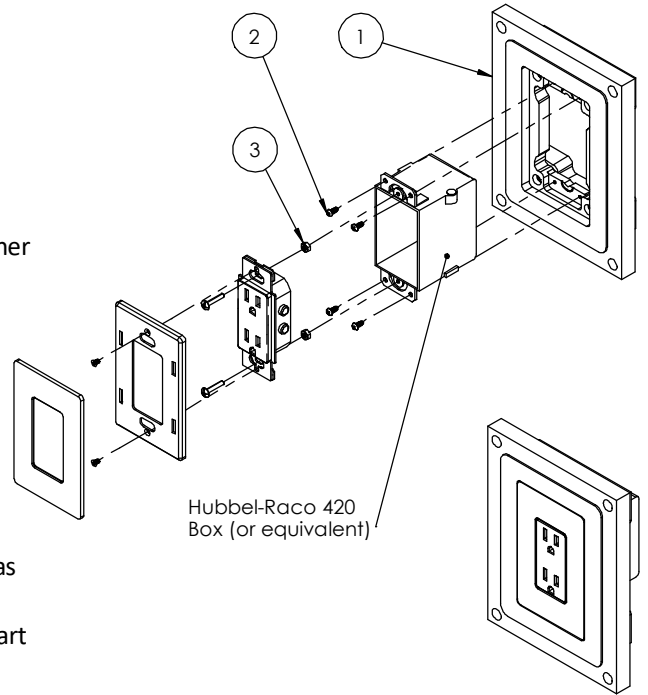

Key properties:

- Dimensions (W/H/D): 144.8mm (5.7")/ 188mm (7.4")/ 38.6mm (1.52")
- Power Supply: None (manual adapter).
- Weight: 0.4Kg, 0.88lbs.
- Material: Moisture resistant MDF.
- To be installed in 5/8” drywall (for installation in 1/2” drywall use SKU# 10-01-101).

