



Model: WS FOR CORE BRANDS KP7 KEYPAD 2gang

Family: WALL-SMART

DWG NO. 10-04-267-SPC



Model No.: 10-01-267

PRODUCT SPEC.

REVISION A

DATE 17/Nov./2014

Make Your Wall Smart

“WS FOR CORE BRANDS KP7 KEYPAD 2gang” - Product description:

The “WS FOR CORE BRANDS KP7 KEYPAD 2gang” is an adapter for in-wall flush installation of 2 Core Brands KP7 keypads.

The “WS FOR CORE BRANDS KP7 KEYPAD 2gang” securely mounts the keypads while allowing easy access, insertion and operation.

Key features and benefits:

- Flush with the wall.
- Paintable with the wall paint in any color and texture.
- Allows easy insertion and removal of the keypad by manual push and magnet detachment of the keypad tray.
- The adapter is supplied unpainted (To be painted after installation as part of the wall).
- Designed to be installed in 1/2” drywall. Installation of the Wall-Smart adapter is straight-forward. Installation process is similar to drywall construction procedures. Before installation, read Wall-Smart installation instruction 10-04-00101-INS in <http://www.wall-smart.com/faq>
- Designed for the use with KP7 keypads (by Core Brands) (keypads not included).
- Adapter kit contains:
 1. Wall adapter;
 2. Keypad adapter;
 3. (8x) ST2.9 Screw;
 4. (4x) Retainer;

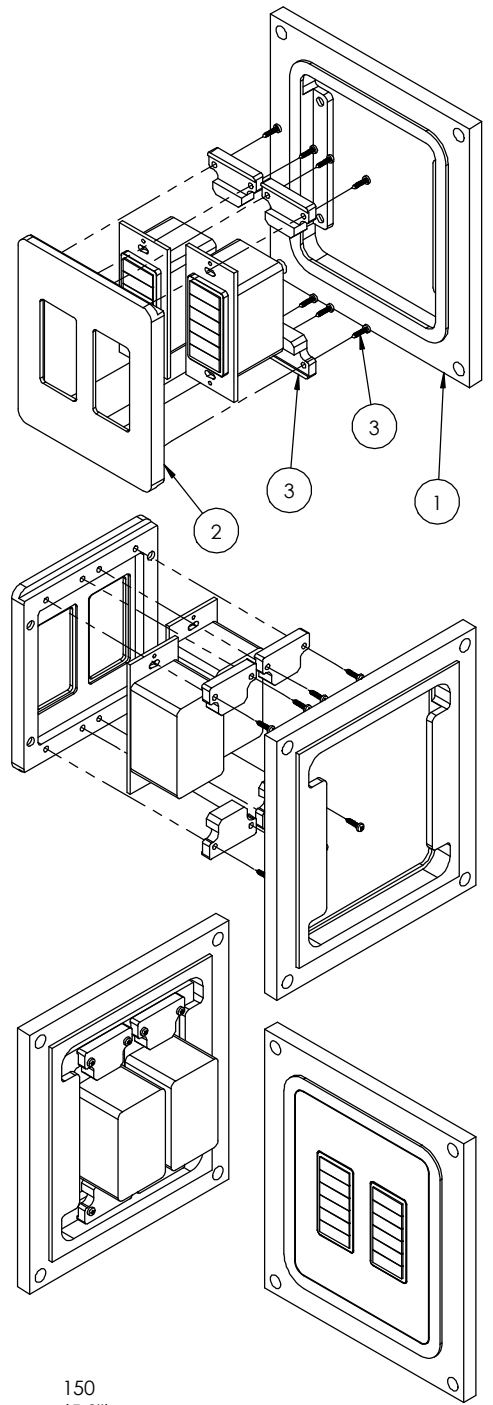

Key properties:

- Dimensions (W/H/D): 186mm (7.32")/ 209.5mm (8.25")/ 16.6mm (0.65")
- Power Supply: None (manual adapter).
- Weight: 0.41Kg, 0.9lbs.
- To be installed in 1/2” drywall.

