



Model: WS for Equinox 41 LCD Keypad 1/2"

Family: WALL-SMART

DWG NO. 10-04-235-SPC

Model No.: 10-01-235

PRODUCT SPEC.

REVISION B

DATE 29/Dec./2014



### Make Your Wall Smart

#### “WS for Equinox 41 LCD Keypad 1/2” - Product description:

The “WS for Equinox 41 LCD Keypad 1/2” is an adapter for in-wall flush installation of an Equinox 41 LCD Keypad.

The “WS for Equinox 41 LCD Keypad 1/2” securely mounts the keypad while allowing easy access, insertion and removal.

#### Key features and benefits:

- Design to be installed in 1/2” thick drywall.
- Flush with the wall.
- Paintable with the wall paint in any color and texture.
- Allows easy insertion and removal of the keypad by manual push and magnet detachment of the keypad tray.
- The adaptor is supplied unpainted (To be painted after installation as part of the wall).
- Installation of the Wall-Smart adapter is straight-forward. Installation process is similar to drywall construction procedures.
- Designed for the use with Vangate Equinox 41 LCD Keypad (keypad not included).
- Adapter kit contains:
  - Wall adapter (item 2)
  - Keypad adapter (item 1)
  - (2x) M3 Screw (item 4)
  - (2x) M3 Nut (item 3)

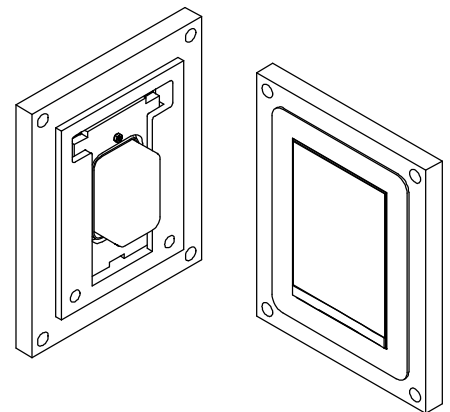
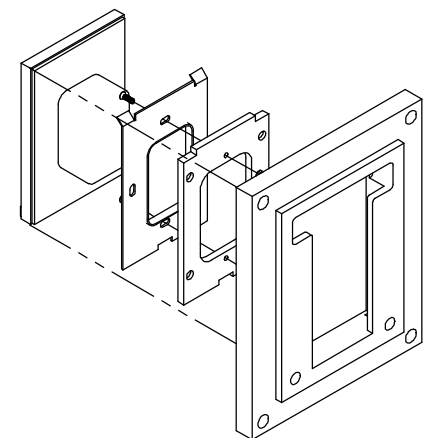
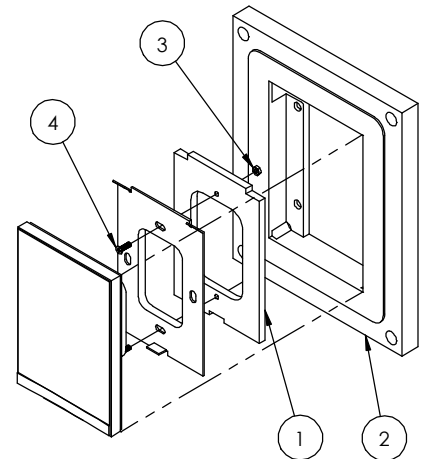

#### Key properties:

- Dimensions (W/H/D): 158.3mm (6.2")/ 197.1mm (7.8")/ 22mm (0.86")
- Power Supply: None (manual adapter).
- Weight: 0.25Kg, 0.55lb.
- To be installed in 1/2” drywall.

