



Model: WS RF FOR LG AC Smart
IV BACnet Gateway

Model No.: 079-1-788

Family: WALL-SMART

DWG NO. 079-4-788-SPC

PRODUCT SPEC.

REVISION A

DATE 05/APR/2021



Make Your Wall Smart

“WS RF FOR LG AC Smart IV BACnet Gateway” - Product description:

The “WS RF FOR LG AC Smart IV BACnet Gateway” is an adapter for in-wall nearly flush retrofit installation of a LG AC Smart IV BACnet Gateway controller

The “WS RF FOR LG AC Smart IV BACnet Gateway” firmly mounts the controller while allowing easy insertion, removal and operation.

Key features and benefits:

- Nearly flush with the wall (4mm [0.16"] thick on-wall bezel).
- Allows easy insertion and removal of the controller.
- Wall mount contains depth calibration mechanism.
- Bezel attaches magnetically to the retrofit wall mount base.
- Board thickness 10mm[0.39"] up to 21mm[0.83"].
- Designed for the use with AC Smart IV BACnet (model PBACNA000 by LG) (not included).
- Adapter kit contains:

1. (X1) Wall adapter;
2. (X1) Controller adapter;
3. (X1) Bezel;
4. (X4) M4X12 screws;
5. (X4) M4 nuts;

Key properties:

- Dimensions: (W/H/D): 307.3mm (12.10")/ 221.6mm (8.72")/ 60.6mm (2.39")
- Weight: 1.0Kg, 2.2lbs.
- Material: Moisture resistant MDF (compliant with TSCA Title VI)

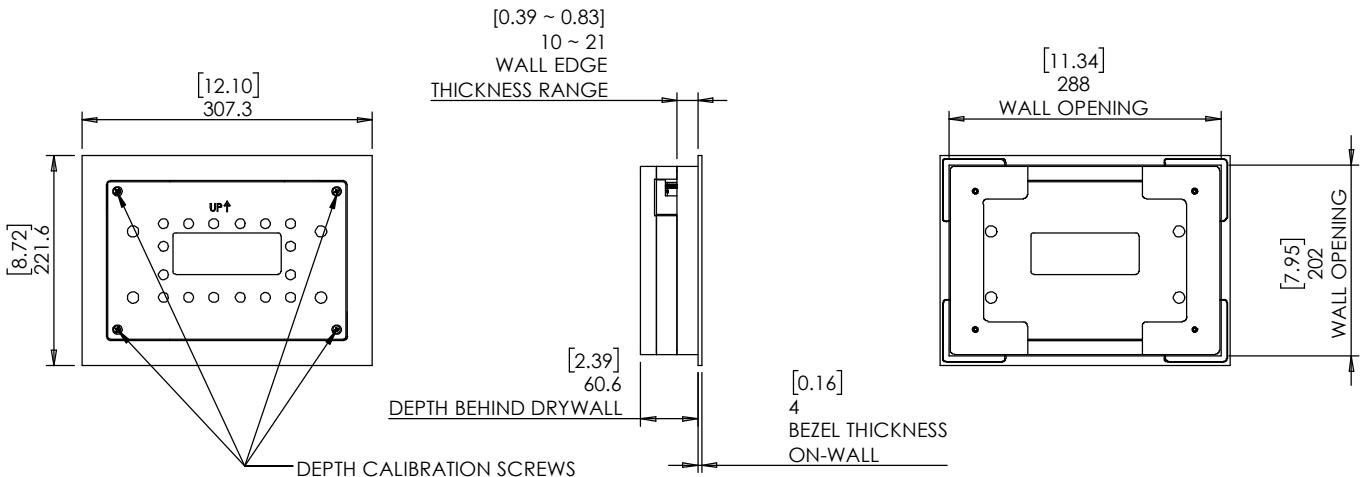
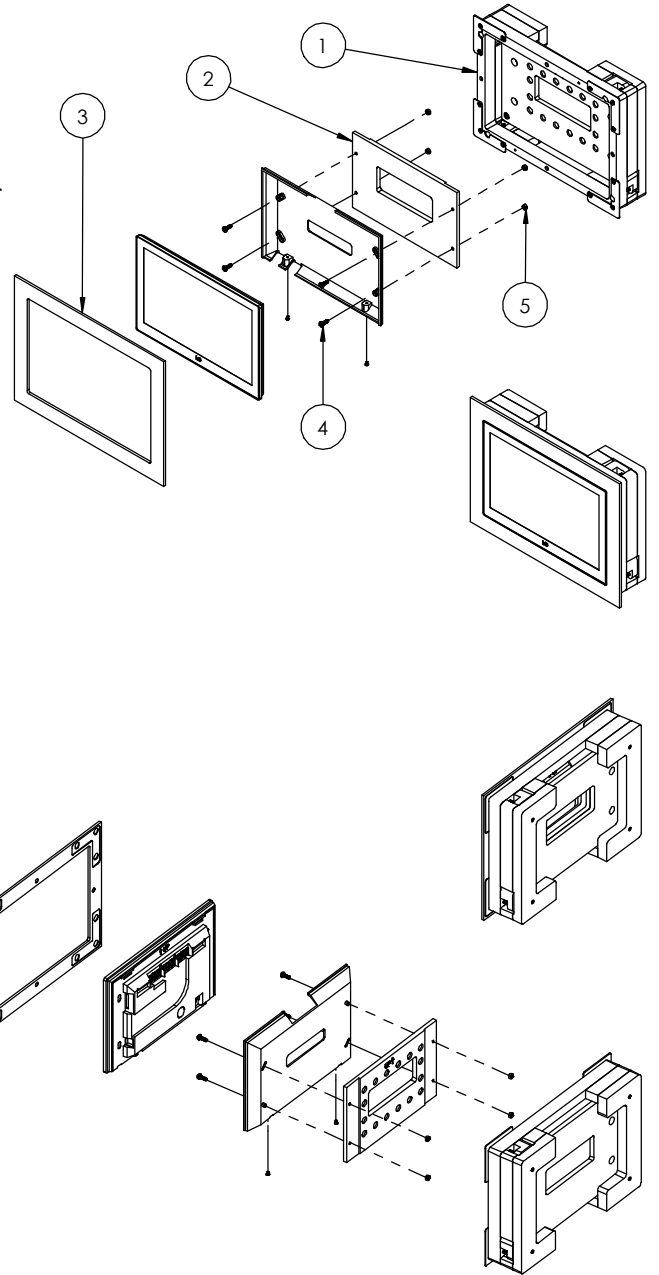



Model: WS RF FOR LG AC Smart
IV BACnet Gateway

Family: WALL-SMART

DWG NO. 079-4-788-SPC

Model No.: 079-1-788

PRODUCT SPEC.

REVISION A

DATE 05/APR/2021

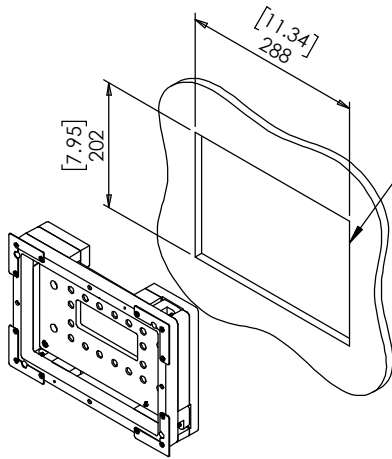

1. CUT OPENING - BOARD THICKNESS 10mm [0.39"]
UP TO 21mm [0.83"] (FOR BOARDS UP TO
32mm [1.25"] THICK, REINSTALL DOG EARS
UPSIDE DOWN.

2. ROUTE NECESSARY CABLES

3. INSERT WALL MOUNT BASE

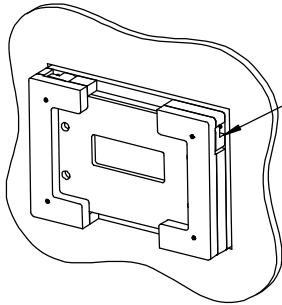

4. GENTLY SCREW CLOCKWISE 4
RETENTION SCREWS UNTIL DOG
EARS RETAIN THE UNIT

5. ATTACH ADAPTER PLATE
TO THE CONTROLLER

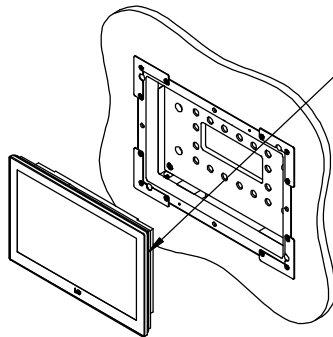

6. INSERT SCREEN

7. ATTACH BEZEL
(MAGNETICALLY)

