



Model: WS NC FOR MICROSOFT SURFACE GO 2

Family: WALL-SMART

DWG NO. 064-4-432-SPC



Model No.: 064-1-432

PRODUCT SPEC.

REVISION A

DATE 13/FEB/2022

**Make Your Wall Smart**

**WS NC FOR MICROSOFT SURFACE GO 2- Product description:**

The "WS NC FOR MICROSOFT SURFACE GO 2" is an adapter for in-wall use of a MICROSOFT SURFACE GO 2" tablet as a control device for Smart home/office/public institutes. The "WS NC FOR MICROSOFT SURFACE GO 2" securely mounts the tablet allowing easy access, insertion and removal.

**Key features and benefits:**

- Flush with the wall.
- Microsoft surface go 2 mounted horizontally (landscape position)
- Camera and microphone are covered.
- Paintable with the wall paint in any color and texture.
- Easy to operate. Electrically locked/unlocked by positioning of the Wall-Smart key over top right door corner (Wall-Smart key included). After unlocking, door manually opened to insert /remove tablet.
- Internal surfaces painted black.
- External surfaces (front panel) are unpainted. To be painted after installation as part of the wall. The adapter is supplied with a paint masking plug.
- Electric lock power supply (12VDC, 0.28A) via power cord attached. (power supply not included)
- Designed to be installed in 1/2" drywall. Installation of the Wall-Smart adapter is straight-forward. Installation process is similar to drywall construction procedures. Before installation, read Wall-Smart installation instruction 10-04-00101-INS in <http://www.wall-smart.com/faq>
- For installation in concrete/block wall use "WS Concrete Box 406x364" P/N 10-01-048 (sold separately) according installation instruction 10-04-00103-INS in <http://www.wall-smart.com/faq>
- Designed for the use with surface go 2 tablet and USB-C travel hub (by Microsoft) (tablet and hub not included)
- Adapter kit contains:
  1. (X1) Wall adapter
  2. (X1) WALL-SMART key
  3. (X1) USB-C 90° adapter

**Key properties:**

- Dimensions (W/H/D): 406mm (16")/ 364mm (14.33")/ 48.3mm (2.39")
- Power Supply: 12VDC, 0.28A (not included)
- Weight: 3.1Kg, 6.8lbs

POSITION WALL-SMART KEY TO OPEN

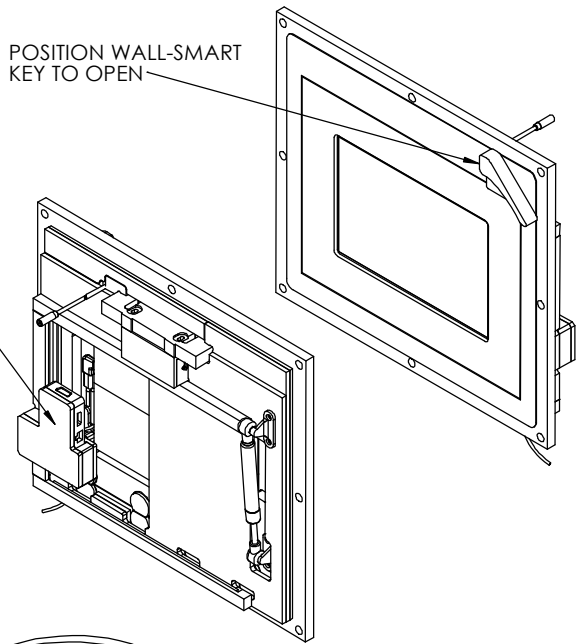

MICROSOFT USB-C® TRAVEL HUB HOLDER

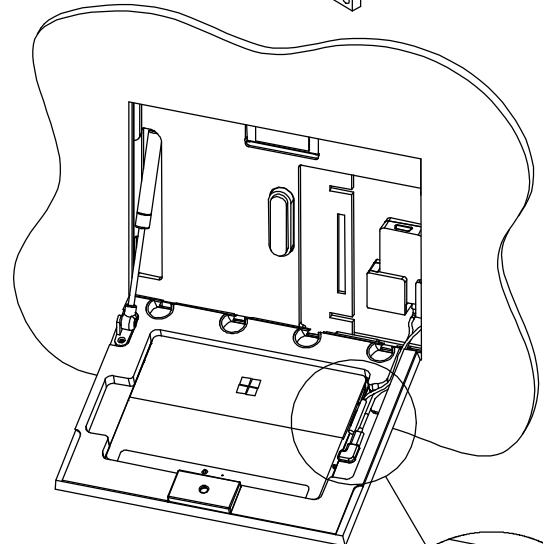

USE THE MICROSOFT CONNECTOR TO POWER THE DEVICE

USE THE SUPPLIED USB-C 90° ADAPTER

MOUNTING SURFACE DESIGNED TO BE INSTALLED IN 1/2" DRYWALL FOR 5/8" DRYWALL USE SHIM 10-01-067

POSITION WALL-SMART KEY TO OPEN

