



Model: WS SB FOR CRESTRON TSW-570

Model No.: 012-1-828

Family: WALL-SMART

DWG NO. 012-4-828-SPC

PRODUCT SPEC.

REVISION A

DATE 22/JUNE/2020



Make Your Wall Smart

“WS SB FOR CRESTRON TSW-570” - Product description:

The “WS SB FOR CRESTRON TSW-570” is an adapter for in-wall flush installation of a TSW-570 touch screen in solid Board walls.

The “WS SB FOR CRESTRON TSW-570” firmly mounts the touch screen while allowing easy insertion, removal and operation.

Key features and benefits:

- Flush with the solid surface wall.
- Wall mount may be mounted in any orientation.
- Allows easy insertion and removal of the touch screen.
- Wall mount contains depth calibration mechanism and spacer allowing installation in solid surface boards of 8.0 [0.31"] up to 34.0 [1.34"] thickness.
- See page 2 for routing dimensions.
- Designed for the use with TSW-570 touch screen by Crestron Electronics, Inc. © (touch screen is not included).
- Adapter kit contains:
 1. (X1) Wall adapter
 2. (X1) Spacer
 3. (X4) ST3x30 screws

Key properties:

- Dimensions: (W/H/D): 163.3mm (6.43")/ 104.8mm (4.13")/ 40.3mm (1.59").
- Power Supply: None (manual adapter).
- Weight: 0.4Kg, 0.88lbs Weight.
- Material: Moisture resistant MDF (compliant with TSCA Title VI).

DEPTH CALIBRATION SCREWS

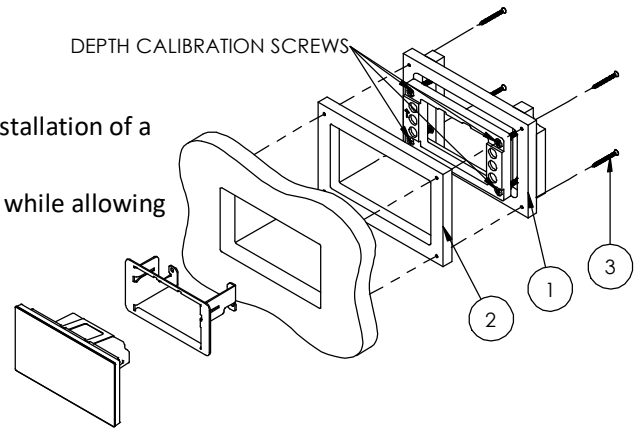

IMPORTANT: ATTACH CRESTRON MOUNTING BRACKET

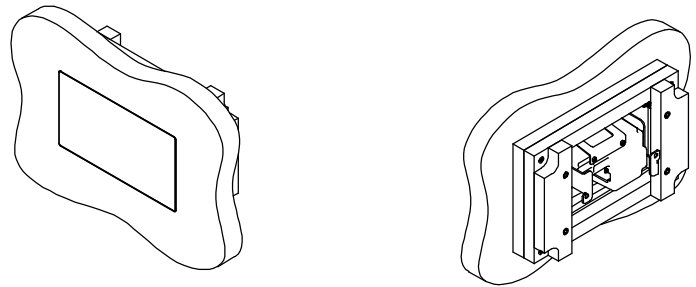
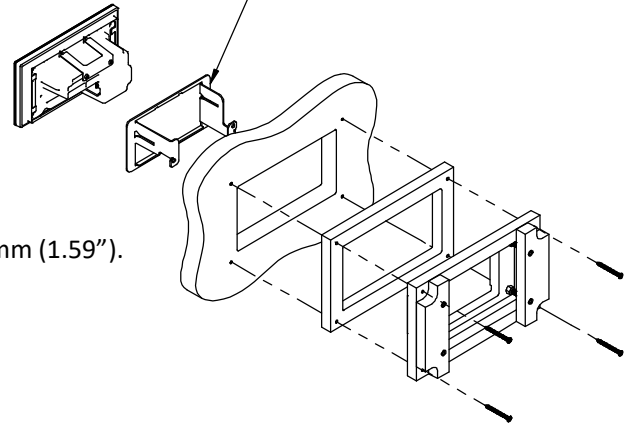

SOLID BOARD THICKNESS RANGE:
8.0 ~ 22.2 [0.31"~0.87"] WITH SPACER
20 ~ 34.0 [0.78"~1.34"] WITHOUT SPACER

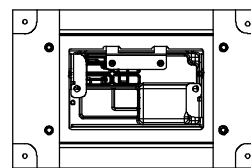
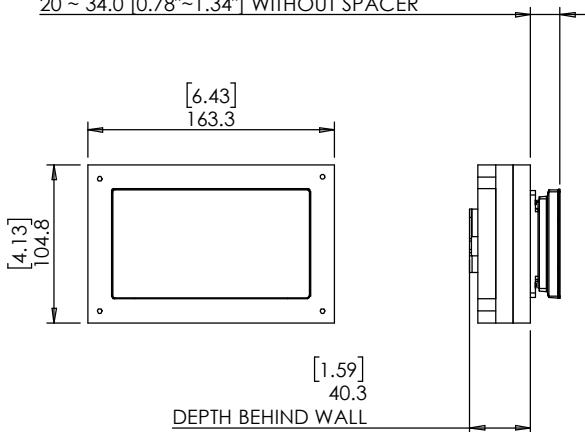

PUSH TO OPEN



Model: WS SB FOR CRESTRON TSW-570

Model No.: 012-1-828

Family: WALL-SMART

DWG NO. 012-4-828-SPC

PRODUCT SPEC.

REVISION A

DATE 22/JUNE/2020



CUTOUT ROUTING TEMPLATE 012-1-828

SCALE 1:1

CONTACT WALL-SMART FOR DXF FILE

