



Model: WS SB FOR CRESTRON HZ2-FP-G3

Family: WALL-SMART

DWG NO. 012-4-762-SPC



Model No.: 012-1-762

PRODUCT SPEC.

REVISION B

DATE 24/AUG./2023

### Make Your Wall Smart

#### “WS SB FOR CRESTRON HZ2-FP-G3” - Product description:

The “WS SB FOR CRESTRON HZ2-FP-G3” is an adapter for in-wall flush installation of an HZ2-FP-G3 faceplate with **low voltage** Horizon™ devices in solid board walls.

The “WS SB FOR CRESTRON HZ2-FP-G3” firmly mounts the faceplate and the devices while allowing easy access, insertion and removal.

#### FOR LOW VOLTAGE USE ONLY!

#### Key features and benefits:

- Allows easy insertion and removal.
- Flush with the wall.
- Allows easy maintenance access.
- Includes depth calibration mechanism and a spacer allowing installation in wide range of board thicknesses:  
With spacer: 10.3mm ~ 23.5mm [0.4" ~ 0.93"] thick.  
Without spacer 21.9mm ~ 35.1mm [0.86" ~ 1.38"] thick.
- Use routing template as spacer.
- Designed for the use with Crestron HZ2-FP-G3 faceplate with **low voltage** Horizon™ devices only (faceplate and devices not included).
- Installation kit contains:
  1. Wall adapter (x1)
  2. keypad adapter (x1)
  3. Routing template (x1)
  4. ST3x40 screws (x4)
  5. CS M3X12 Screws (x6)
  6. M3 Nuts (x6)

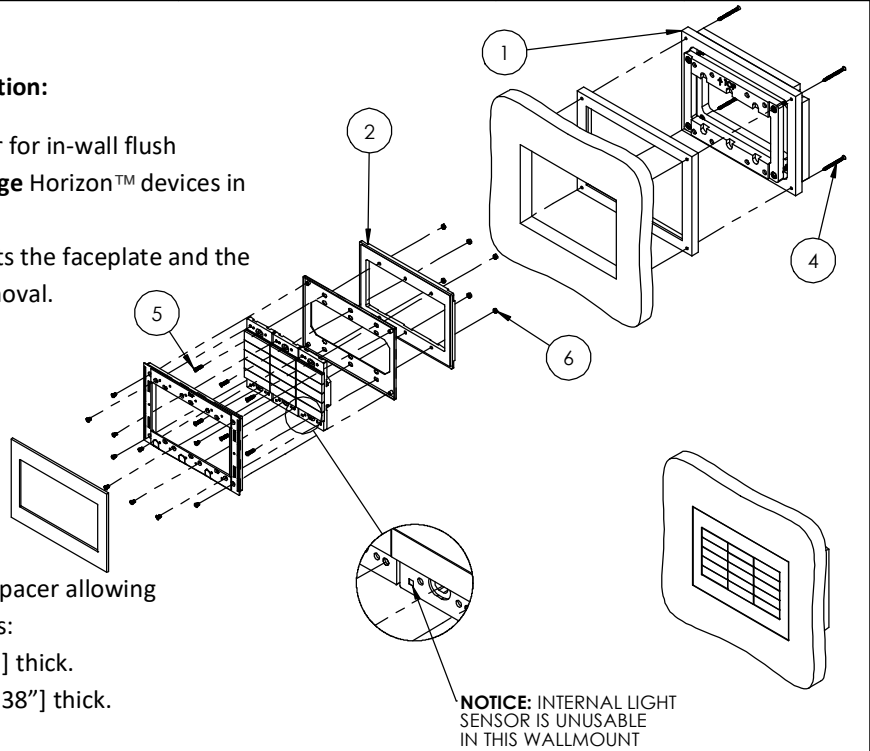

INSTALL WITH SPACER, MULTIGANG ALIGNMENT (2049924)

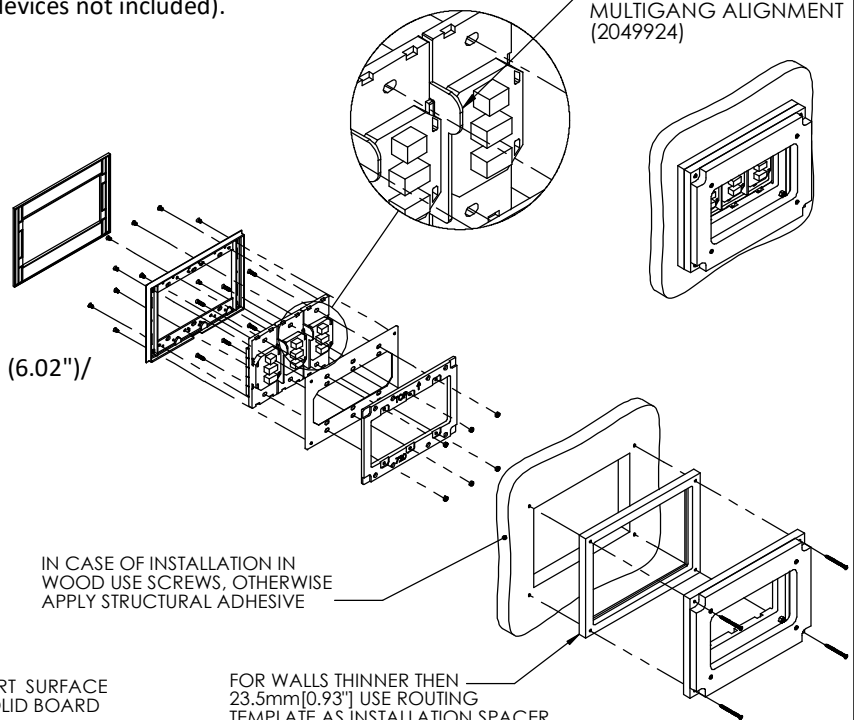

#### Key properties:

- Dimensions (W/H/D): 156.8mm (6.17")/ 152.8mm (6.02")/ 39.5mm (1.56")
- Power Supply: None (manual adapter).
- Weight: 0.5Kg, 1.1lbs.
- Material: Moisture resistant MDF

SOLID BOARD THICKNESS RANGE:  
10.3 ~ 23.5 [0.4" ~ 0.93"] WITH SPACER  
21.9 ~ 35.1 [0.86" ~ 1.38"] WITHOUT SPACER

FRONT SURFACE OF SOLID BOARD

FOR WALLS THINNER THEN 23.5mm[0.93"] USE ROUTING TEMPLATE AS INSTALLATION SPACER

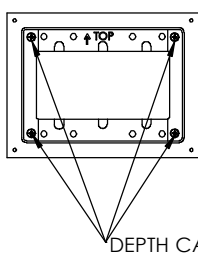

[1.56]  
39.5

DEPTH CALIBRATION SCREWS

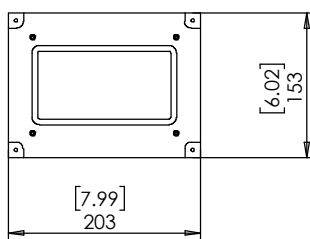

[7.99]  
203

[6.02]  
153

PUSH TO OPEN



Model: WS SB FOR CRESTRON HZ-FP-G3

Family: WALL-SMART

DWG NO. 012-4-762-SPC

Model No.: 012-1-762

PRODUCT SPEC.

REVISION A

DATE 04/JULY/2021



# ROUTING TEMPLATE

012-1-762

1:1 SCALE

MARK SCREW LOCATIONS

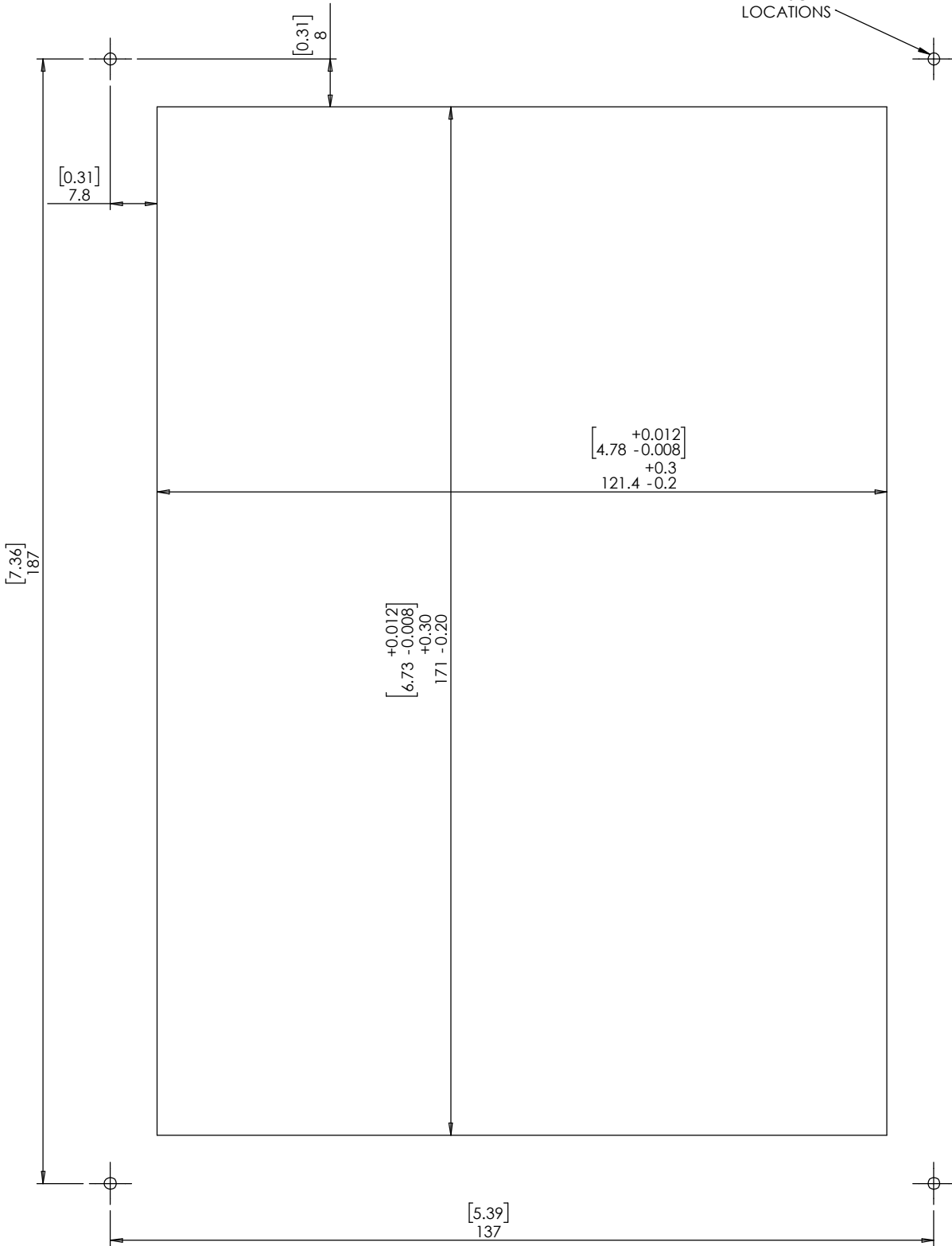

**PRINT THIS PAGE 1:1 SCALE**